

SWC Loop 101 & Northern Avenue

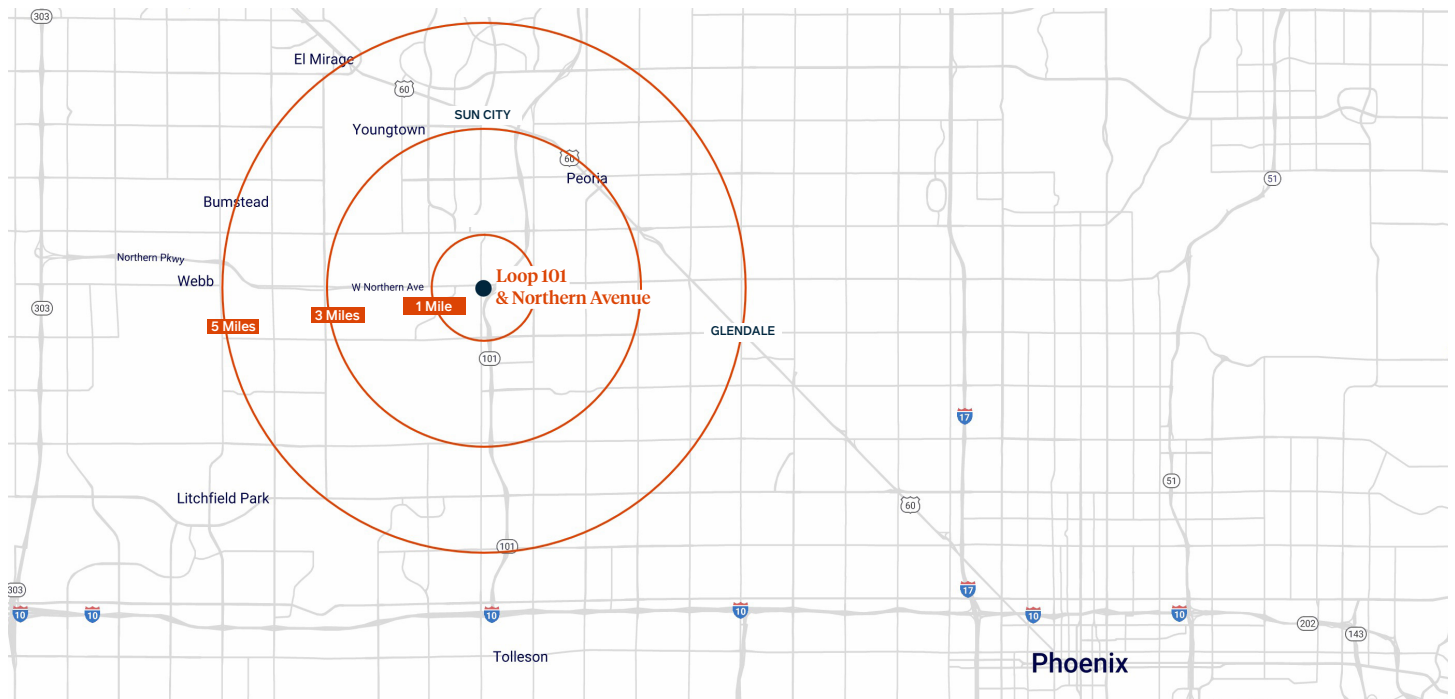

SEC CORNER OF N 99TH AVENUE & W NORTHERN AVENUE

Area Highlights

- Located along Loop 101 at 99th Avenue and Northern Avenue, this site is approximately 24 acres and ripe for development.
- The location is located directly across from Park West, a shopping center featuring quality name brand national, and regional brands including Harkins Theatre, Victoria's Secret, Bath & Body Works, Flemings, BJ's Brewhouse (top grossing BJ's in AZ), Chico's, Vans, and others.
- Less than 3 miles to popular sports and tourism venues:
 - State Farm Stadium, home of the Arizona Cardinals. Since opening in 2006, every home game has sold out. In addition to NFL games, State Farm Stadium has also hosted to two Fiesta Bowl games, concerts, and as well as other entertainment events and activities. The stadium can hold up to 73,000 visitors.
 - Gila River Arena, home of the NHL Arizona Coyotes, is the southern-most anchor of Westgate Entertainment District, a sports and entertainment development. Gila River Arena hosts sports events as well as concerts and other live events.
 - TopGolf Glendale features 100+ climate controlled hitting bays, a full-service restaurant & bars, rooftop terrace, and private event spaces with meeting rooms.

2021 EST.

Demographics

	1 mile	3 miles	5 miles
Population	5,372	73,544	298,571
Employee Population	1,620	19,059	59,551
Average Household Income	\$51,018	\$71,683	\$71,316
Median Household Income	\$49,817	\$62,240	\$60,572

LEASING CONTACTS

Our Team



Jake Heims

SENIOR DIRECTOR, RETAIL SALES & LEASING

jheims@thompsonthrift.com

Direct / 602-313-8636

Mobile / 480-297-7561



Chris Hake

SENIOR VICE PRESIDENT,
DIRECTOR OF SOUTHWEST REGION, RETAIL

chake@thompsonthrift.com

Direct / 602-313-8632

Mobile / 317-519-8446

SWC Loop 101 & Northern Avenue

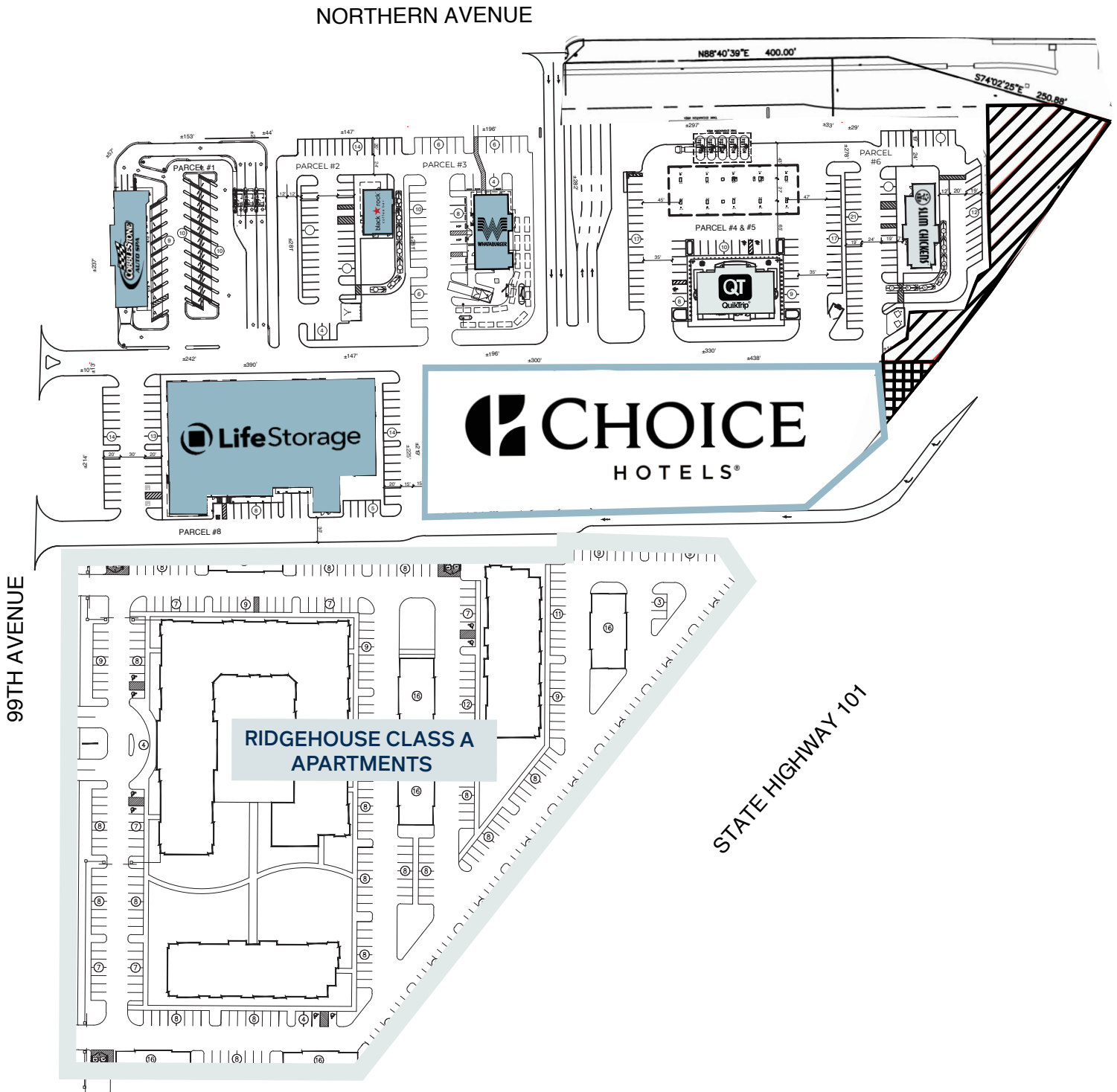

KEY

Available Neg. LOI Neg. Lease / PSA Signed Sold

Jake Heims

SENIOR DIRECTOR, RETAIL SALES & LEASING Direct / 602-313-8636
jheims@thompsonthrift.com Mobile / 480-297-7561

111 Monument Circle, Suite 1500, Indianapolis, IN 46204
ThompsonThrift.com



SWC Loop 101 & Northern Avenue



Jake Heims

SENIOR DIRECTOR, RETAIL SALES & LEASING **Direct** / 602-313-8636
 jheims@thompsonthrift.com **Mobile** / 480-297-7561

111 Monument Circle, Suite 1500, Indianapolis, IN 46204
ThompsonThrift.com

